

**VALVOLA DI RITEGNO ASSIALE
SILENT CHECK VALVE FLANGED**

**PN 16 Art. C086 T
PN 10 Art. C087 T**

VALVOLA DI RITEGNO ASSIALE PN10/16

AXIAL DISC CHECK VALVE PN10/16

APPLICAZIONE:

Stazioni di pompaggio per acqua, irrigazione e depurazione acque.

APPLICATION:

Pumping stations and networks for clean water distribution, irrigation and water treatment.

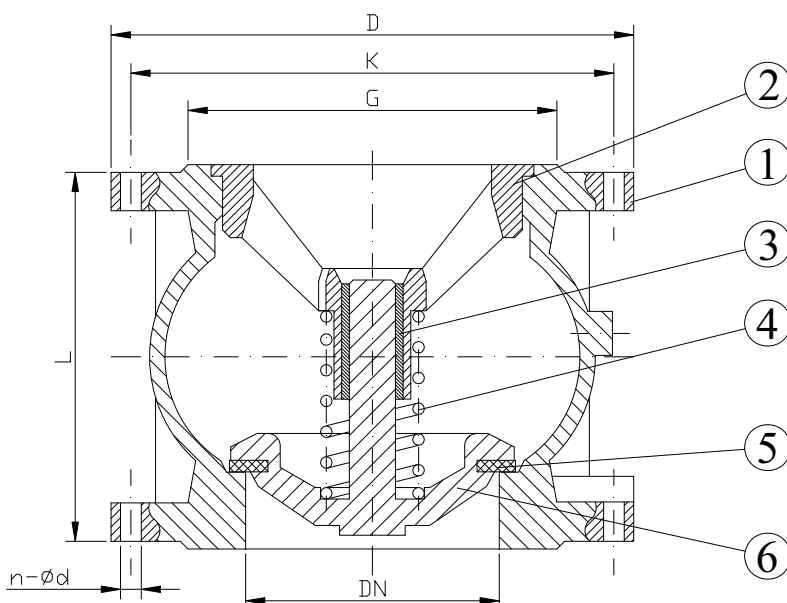
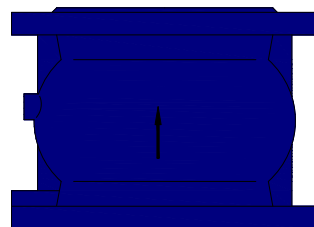

NORMA PROGETTO: EN 1074-3
SCARTAMENTO: EN 558-1
FLANGE: EN1092-2
COLLAUDI: EN 12266
TEMPERATURA ESERCIZIO: Min -10°C/Max+70°C
PRESSIONE ESERCIZIO: Min 0,3 bar - Max 10/16 bar

DESIGN STANDARD: EN 1074-3
FACE TO FACE: EN 558-1
FLANGES: EN1092-2
TESTS: EN 12266
WORKING TEMPERATURE: Min -10°C/Max+70°C
WORKING PRESSURE: Min 0,3 bar - Max 10/16 bar

**DENOMINAZIONE
PART**

**MATERIALI
MATERIALS**

DENOMINAZIONE PART	MATERIALI MATERIALS
1 CORPO BODY	GJL 250 GJL 250
2 GUIDA GUIDE	GJS 400 + OTTONE GJS 400 + BRASS
3 ASSE GUIDA GUIDING STEM	OTTONE BRASS
4 MOLLA SPRING	ACCIAIO INOX STAINLESS STEEL
5 GUARNIZIONE SEAL	EPDM EPDM
6 DISCO DISC	GJS 400 GJS 400

DN	PN	G	K	D	n-d	L	Peso(kg) Weight
50	16	98	125	165	4-ø19	100	5.7
65	16	118	145	185	4-ø19	120	8.7
80	10	132	160	200	4-ø19	140	10.8
	16	132	160	200	8-ø19	140	10.8
100	16	156	180	220	8-ø19	170	13.5
125	16	184	210	250	8-ø19	200	21
150	16	211	240	285	8-ø23	230	30
	10	260	295	340	8-ø23	300	49
200	16	260	295	340	12-ø23	300	49
	10	319	350	405	12-ø23	370	73.3
250	10	319	350	405	12-ø23	370	73.3
	16	319	355	405	12-ø28	370	73.3

RIVESTIMENTO ESTERNO/INTERNO: Polvere epossidica di colore blu RAL 5005 con spessore min 200µm.

SURFACE PROTECTION: FBE coating process with epoxy resin powder of sky blue color RAL 5005 and minimum thickness of 200µm.